

INVS M3 Series

Solar Energy Storage Inverter

3-5KVA

Battery Optional

1kW=1kVA

Bluetooth



Product Snapshot

Model: 3-5kW

Nominal Voltage: 230VAC

Frequency Range: 50Hz/60Hz

Battery independency

With battery connected

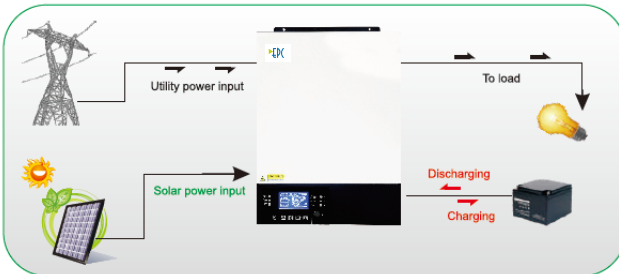

Without battery connected

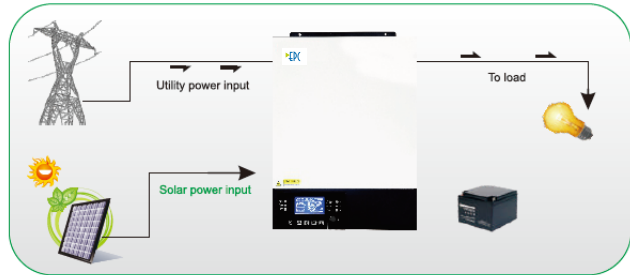

Key Features:

- Output power factor PF=1.0 .
- Configurable AC/Solar Charger priority via LCD setting .
- Compatible to mains voltage or generator power .
- Overload ,Over temperature ,Short circuit protection .
- Integrated Bluetooth interface with Android App.
- Supports USB On-the-Go function.
- Reserved communication port (RS-485, CAN-BUS or RS-232) for BMS.
- Battery independency.
- User-friendly LCD operation.
- Replaceable fan design.

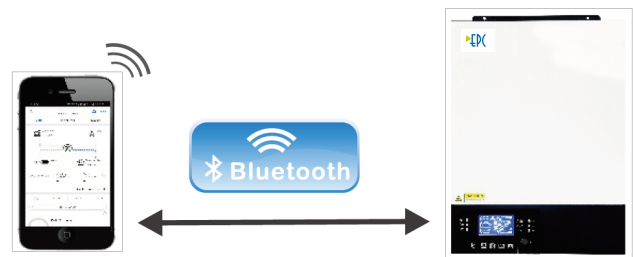

Detachable LCD control module with various communications

This detachable LCD control module can be taken off as a remote panel .Users can install the LCD panel in accessible area away from inverter up to 20 meters.



INVS M3 Series

Wall Mounted Integrated Solar Power Inverter Technical Specification Built-in MPPT Solar Controller

MODEL	INVS M3 3k-24	INVS M3 5k-48
Rated Power	3000VA/3000W	5000VA/5000W
INPUT		
Voltage	230 VAC	
Selectable Voltage Range	170-280 VAC (For Personal Computers) 90-280 VAC (For Home Appliances)	
Frequency Range	50 Hz/60 Hz (Auto sensing)	
SOLAR CHARGER & AC CHARGER		
Solar Charger type	MPPT	
Maximum PV Array Power	4000W	5000W
MPPT Range @ Operating Voltage	120 ~ 450 VDC	
Maximum PV Array Open Circuit Voltage	500 VDC	
Maximum Solar Charge Current	80A	
Maximum AC Charge Current	60A	
Maximum Charge Current	80A	
BATTERY		
Battery Voltage	24 VDC	48 VDC
Floating Charge Voltage	27 VDC	54 VDC
Overcharge Protection	33 VDC	63 VDC
OUTPUT		
AC Voltage Regulation (Batt. Mode)	230VAC \pm 5%	
Surge Power	6000VA	10000VA
Efficiency (Peak)	Up to 93.5%	
Transfer Time	10 ms (For Personal Computers) 20 ms (For Home Appliances)	
Waveform	Pure sine wave	
PHYSICAL		
Dimension, D x W x H (mm)	115 x 300 x 400	
Net Weight (kgs)	9	10
Communication Interface	USB/RS232/RS485/Bluetooth/Dry-contact	
OPERATING ENVIRONMENT		
Humidity	5% to 95% Relative Humidity (Non-condensing)	
Operating Temperature	-10°C to 50°C	
Storage Temperature	-15°C to 60°C	

Note: Product specifications are subject to change without further notice.